

NOTES:

1. ALL WORK IN ACCORDANCE WITH THE RELEVANT NATIONAL STANDARDS AND SPECIFICATIONS, THE LOCAL AUTHORITIES OR STATUTORY BODIES.
2. WHERE REFERENCE IS MADE TO THE SOUTH AFRICAN STANDARD SPECIFICATIONS, THE CURRENT EDITION SHALL BE USED.
3. REFER TO ARCHITECTS LAYOUTS FOR SETTING OUT INFORMATION.
4. ALL DIMENSIONS AND LEVELS TO BE CHECKED ON SITE PRIOR TO CONSTRUCTION. ANY DISCREPANCIES SHOULD BE REPORTED TO THE ENGINEER IMMEDIATELY.
5. ONLY WRITTEN DIMENSIONS AND LEVELS SHALL BE USED.
6. THIS DRAWING TO BE READ IN CONJUNCTION WITH DRAWINGS FROM THE RELEVANT DISCIPLINES, ARCHITECT, CIVIL, ELECTRICAL AND MECHANICAL.
7. THE CONTRACTOR SHALL GIVE THE ENGINEER AT LEAST 24 HOURS ADVANCE NOTICE FOR INSPECTIONS.
8. THE ENGINEER SHALL BE NOTIFIED IMMEDIATELY SHOULD THERE BE ANY DISCREPANCIES BETWEEN DRAWINGS, DETAILS AND SPECIFICATIONS.
9. FOUNDATION EXCAVATIONS TO BE INSPECTED AND APPROVED BY THE STRUCTURAL / GEOTECHNICAL ENGINEER BEFORE ANY BLINDING IS CAST.
10. REINFORCING TO BE CHECKED AND APPROVED BY THE ENGINEER PRIOR TO CASTING CONCRETE.
11. ALL DUCTS OR RECESSES TO BE APPROVED BY THE ENGINEER.
12. POSITION OF CONSTRUCTION JOINTS TO BE APPROVED BY THE ENGINEER.
13. CONCRETE STRENGTHS @ 28 DAYS:
FOUNDATIONS : 25 MPa
COLUMNS : 30 MPa
CONCRETE SLABS : 30 MPa
ROOF SLABS : 30 MPa
BEAMS : 30 MPa
14. COVER TO STEEL REINFORCEMENT: U.O.N.
FOUNDATIONS : 50 mm
COLUMNS : 30 mm
BEAMS : 30 mm
COLUMNS : 30 mm
15. ALL SHARP EXPOSED EDGES TO BE CHAMFERED 20 x 20mm.
16. ALL WATERPROOFING TO ARCHITECT'S DETAIL.
17. SAW CUTS ARE TO BE MADE AS SOON AS THE CONCRETE IS FIRM ENOUGH NOT TO BE TORN OR DAMAGED BY THE CUTTING BLADE (USUALLY BETWEEN 1 TO 3 DAYS OF SET CONCRETE).
18. ALL STEELWORK TO BE FABRICATED AND ERECTED IN ACCORDANCE WITH SANS 5001:2016 SANS 1921-3.
19. ALL STEELWORK TO BE SANS 5002:2005:AFR UNLESS OTHERWISE NOTED.
20. A COMPLETE SET OF SHOP DRAWINGS SHALL BE SUBMITTED TO THE ENGINEER FOR APPROVAL BEFORE FABRICATION COMMENCES.
21. ALL WELDS TO BE MINIMUM 8mm CONTINUOUS ALL JOINTS TO BE MINIMUM 8mm CONTINUOUS IN STRICT ACCORDANCE WITH SANS AND ASSAWE'S STANDARDS.
22. ALL BOLTS SHALL BE GRADE 8.8 UNLESS OTHERWISE NOTED.
23. ALL STEELWORK TO BE HOT DIPPED GALVANISED TO SANS 1200:HC AND SANS 1211 UNLESS OTHERWISE NOTED.

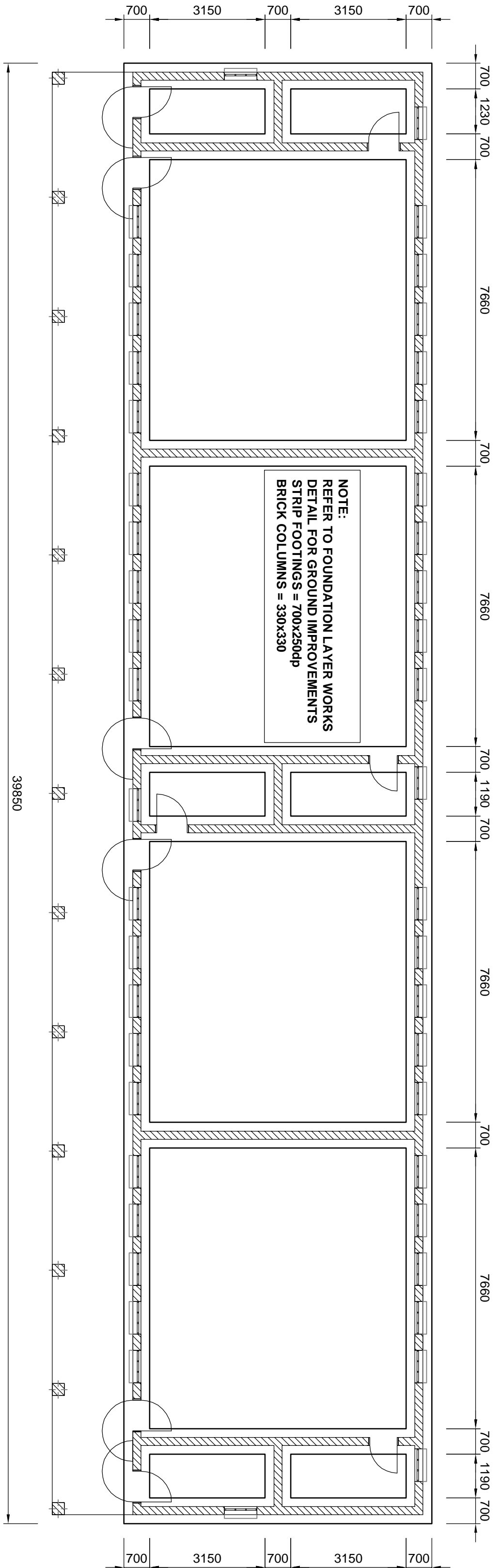

SINGLE STOREY 4 CLASSROOM BLOCK: FOUNDATION RC LAYOUT

SCALE 1:100

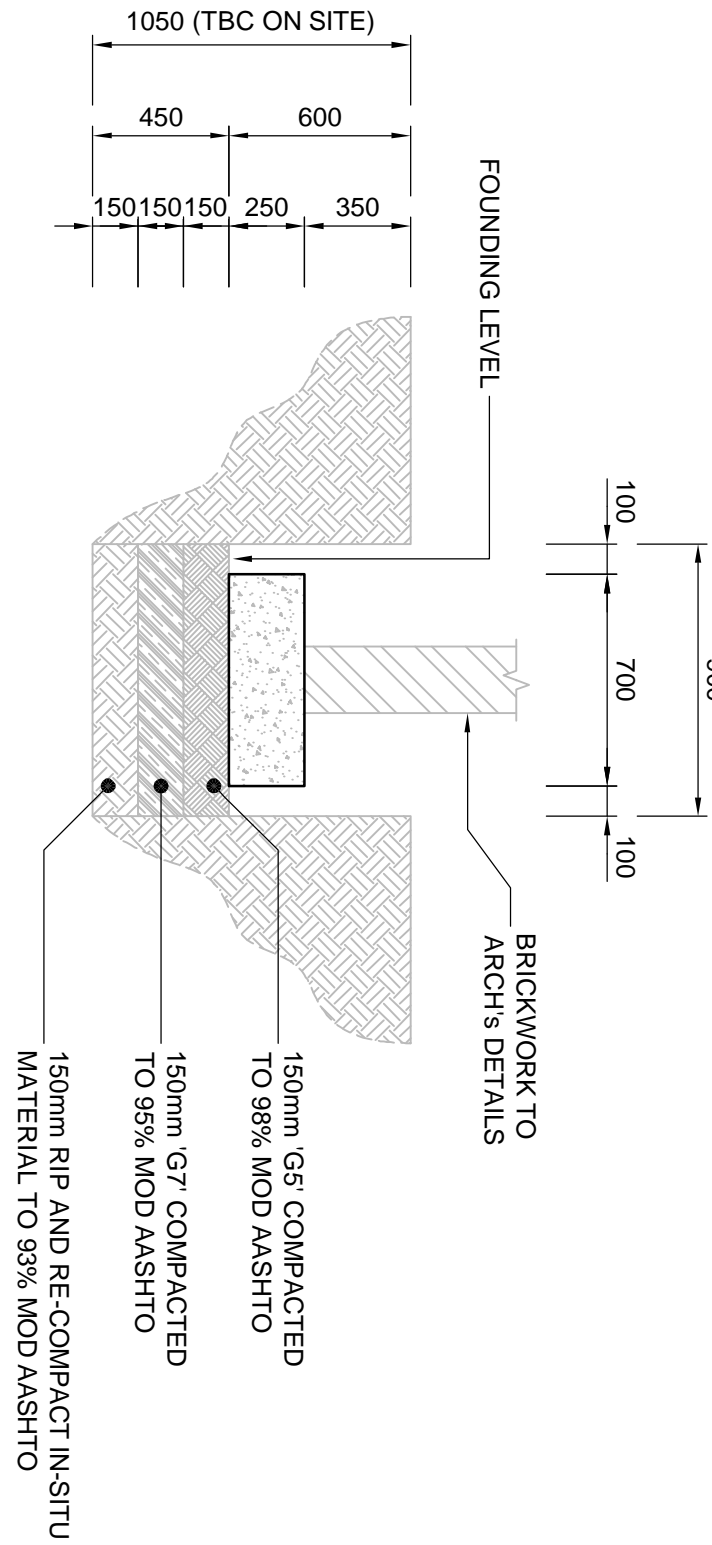

FOUNDATION LAYERWORKS 1

SCALE 1:25

THIS DRAWING TO BE READ IN CONJUNCTION WITH ARCHITECTS LAYOUTS.
REFER TO DRAWING NUMBER SAB1777-TCSS-173 FOR DETAILS.



PROJECT
DBSA SCHOOLS FS
THAKAMESO COMPREHENSIVE SECONDARY SCHOOL,
FREE STATE

DRAWING

FOUNDATION RC LAYOUTS
SINGLE STOREY 4 CLASSROOM

RESPONSIBLE PERSON		DATE
DRAWN	MG	2023-11-28
CHECKED	KT	2023-11-29
APPROVED	MAN OVENBERG PRJ ENQ. 2023(14)	2023-11-29
SCALE	AS SHOWN	SHEET SIZE
PROJECT NUMBER	DRAWING NUMBER	STATUS
		REVISION
		NO

SAB1777-TCSS-171-P-00

DRAWING STATUS CODES :
R - REVISOR
D - DRAFT
1 - TENDER
P - PRELIMINARY
C - COMPLETION
A - AS-BUILT

COPYRIGHT RESERVED